

SUMO

INVESTMENT PROTECTION

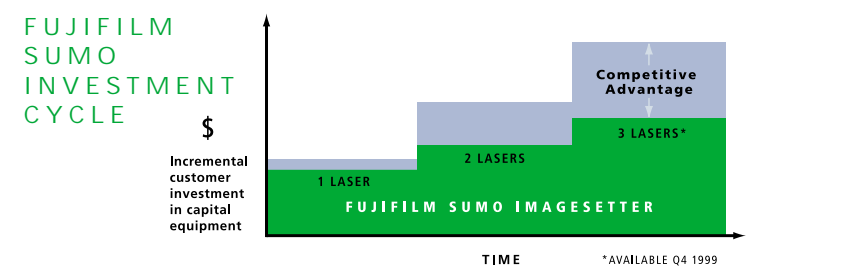
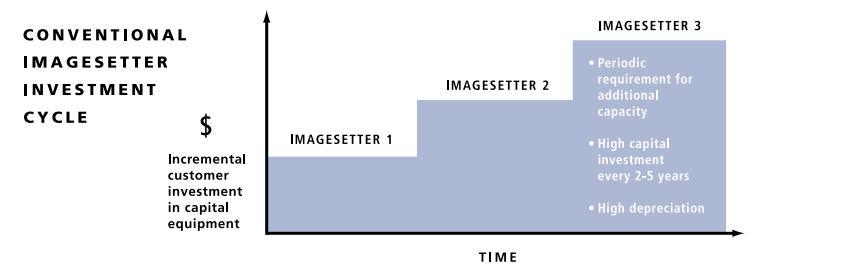
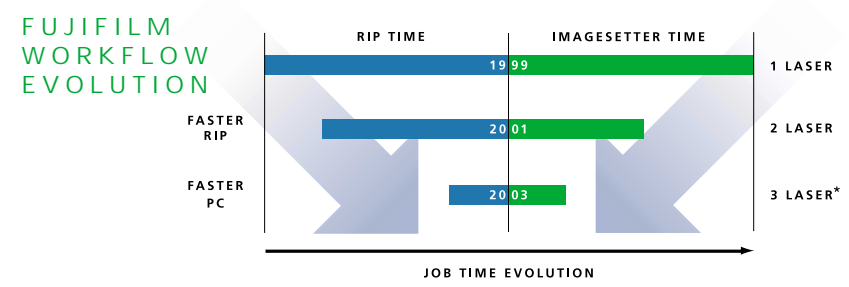
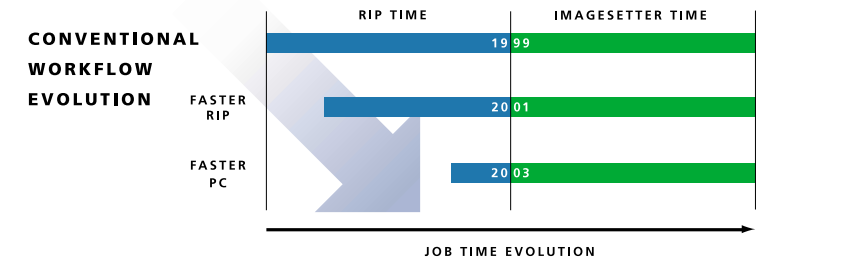

Any imagesetter purchase represents a significant investment. Rapid advances in imagesetter and RIP technology make system upgrades necessary to remain competitive. Traditionally, RIP platforms have been upgraded as computer technology improves, while the imagesetting hardware remains unchanged.

In an effort to make the most of the initial investment, many customers seek to trade in their original units when purchasing a replacement imagesetter. Sumo's multi-laser technology makes this unnecessary. With the ability to upgrade both the RIP platform as well as the imagesetter itself, productivity can be greatly increased at a much lower cost because the original imagesetter remains in use. This allows Sumo to satisfy production requirements for years to come.

SPECIFICATIONS

- Sumo Luxel F9000
- FORMAT**
- Maximum media size: 44.5" x 36.6"
 - Maximum imaging size: 44.1" x 36.6"
 - Full size plate ready film in positive and negative modes
- VARIABLE RESOLUTIONS**
- 1219 dpi
 - 1828 dpi
 - 2438 dpi
 - 3657 dpi*
 - *Available option for one-laser version
- SCREENING**
- 65 to 400 lpi screen rulings
 - Fujifilm Quality Screening
 - FM Screening support
 - Adobe® Accurate™ Screening
 - Harlequin Precision Screening™ (HPS™)
 - Harlequin Dispersed Screening™ (HDS™)
- PUNCHING**
- U.S. Bacher or Stoesser standard; Custom options available.
- IMAGING SPEED (ins²/min)**
- | Resolution | 1 laser | 2 laser | 3 laser* |
|------------|---------|---------|----------|
| 1219 dpi | 901 | 1802 | 2703 |
| 1828 dpi | 600 | 1201 | 7802 |
| 2438 dpi | 451 | 901 | 1351 |
| 3657 dpi | n/a | 600 | 901 |
- 8-UP FLATS PER HOUR**
- | Resolution | 1 laser | 2 laser | 3 laser* |
|------------|---------|---------|----------|
| 1219 dpi | 29 | 46 | 58 |
| 1828 dpi | 21 | 35 | 46 |
| 2438 dpi | 16 | 29 | 38 |
| 3657 dpi | n/a | 21 | 29 |
- VARIABLE MEDIA WIDTHS**
- 22", 30", 42", 44.5"
- MEDIA THICKNESS**
- 0.004" and 0.007"
- MULTIPLE MEDIA SUPPLY**
- Dual on-line cassettes
 - Operator friendly, "drop in" daylight media loading
 - Cassette database (up to 7 cassettes)
- *Available Q4 1999
- IMAGING**
- Precision engineered, internal "C" drum
 - Upgradeable, advanced multi-laser technology
 - High speed spinner control
 - Fully automatic film transportation
- LIGHT SOURCE**
- Red laser diode @ 635 nm wavelength
- USER INTERFACE**
- Innovative touch screen control panel
- SOFTWARE SUPPORT**
- Choice of CelebraNT RIP, HQ RIP or Rampage
- RIP - RECORDER INTERFACE**
- Ultra wide SCSI
- PROCESSOR**
- High speed Glunz & Jensen AP1250X
- MEDIA TYPE**
- Red sensitive, roll fed
 - Fujifilm HQ
- ENVIRONMENT**
- Operating range – Temperature: 65 – 78°F
 - Humidity: 40 – 60% non-condensing
 - Optimum range – 73 ± 5°F
 - 55 ± 5% RH
- FOOTPRINT**
- Height: 55"
 - Width: 79"
 - Depth: 43"
 - Weight: 1653 lbs.



1285 Hamilton Parkway, Itasca, IL 60143
630-773-7200 800-877-0555 FAX 630-773-7999
www.fujifilm.com

©1999 Fuji Photo Film, U.S.A., Inc. Printed in U.S.A. Photographed, separated, proofed and printed using Fujifilm products. Specifications subject to change without notice. All trademarks are the property of their respective holders.

SUMO-2

OUTPUT SYSTEMS

SUMO

LUXEL F9000

Luxel F-9000

LARGE FORMAT IMAGESETTER

FUJIFILM GRAPHIC SYSTEMS

SUMO

THE QUICK AND POWERFUL MULTI-LASER IMAGESETTER THAT'S FULLY UPGRADEABLE

IT WILL GROW AS YOUR PRODUCTION GROWS.

When investing in a new imagesetter, you need a machine that cost-effectively meets your current output requirements without becoming obsolete as soon as production demands increase. Sumo's multi-laser technology makes this the first imagesetter to be truly upgradeable to clearly defined levels of advanced productivity.

IT'S LIGHTNING FAST.

With just one laser, Sumo produces up to 29 full size flats per hour at 1219 dpi. A simple, cost-effective field upgrade to add another laser will double imaging speed. A third laser takes Sumo to the next level, which raises the bar against competitive imagesetters in its class.

LARGEST FORMAT SIZE IN ITS CLASS.

Sumo outputs full size plate ready positive or negative film with an image area up to 44.1" x 36.5". With support for variable media widths, Sumo maximizes flexibility, minimizes film waste and increases profitability.



- SUMO FEATURES**
- Multi-laser technology gives unrivaled productivity – up to 29 plate ready flats per hour @ 2438 dpi with 2 lasers.
 - Simple, field upgrade (to 2 or even 3 lasers) *at least* doubles imaging speed, protecting your initial hardware investment.
 - Dual on-line drop-in film cassettes make film loading fast and easy.
 - Innovative cassette database for up to 7 cassettes – identifies film width, thickness, type, and even amount left in cassette.
 - Internal image buffer – multiple jobs can be downloaded while others are simultaneously being exposed.
 - On-line high speed processor.
 - Supports a variety of RIPs – CelebraNT RIP, HQ RIP or Rampage.
 - User friendly, touch screen interface.
 - Fully automatic film transportation.
 - Film is automatically punched, exposed, cut and processed and ready for burning plates.
 - Variable media widths and thicknesses.
 - Maximum media size: 44.5" x 36.6"

SUMO CONFIGURATIONS

STANDARD	OPTIONS
One Laser	• 1 to 2 laser upgrade with additional 3657 dpi resolution
• Single laser, dual cassette and 3 resolution levels (1219, 1828, and 2438 dpi) Stoesser or U.S. Bacher punch	• 2 to 3 laser upgrade*
Two Lasers	• 3657 dpi resolution upgrade for 1 laser unit
• Dual laser, dual cassette and 4 resolution levels (1219, 1828, 2438 and 3657 dpi) Stoesser or U.S. Bacher punch	• Additional film input cassettes
Three Lasers	• On-line film punching (customized versions produced to order)
• Q4 1999	*Available Q4 1999

SUMO

PATENTED MULTI-LASER TECHNOLOGY MEANS
UNSURPASSED WORKFLOW

Sumo Luxel F9000 Standard Punch Configurations

Sumo can image plate-ready film in all modes and can automatically punch the long edges of the film to ensure maximum registration accuracy, saving time and money, and getting jobs to press more quickly. Combined with a high speed processor, output capacity is unrivaled. With the world's fastest imagesetter at your disposal, you can take those "impossible" jobs in stride.

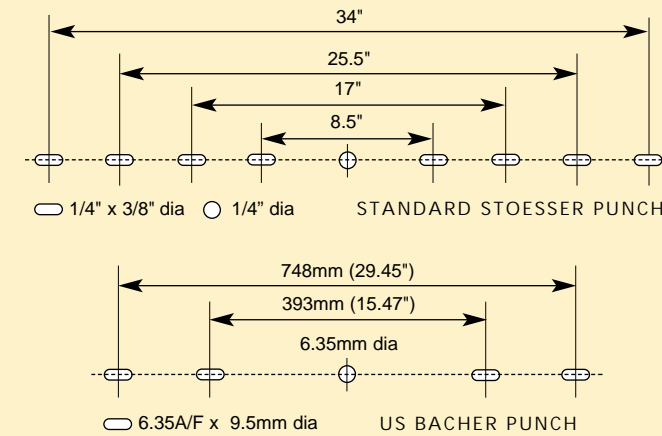

BACKGROUND TECHNOLOGY

The performance of internal drum imagesetters has traditionally been governed by the spinner mirror. The speed at which this mirror rotates is key to the overall productivity of the machine. Physical limitations constrain maximum rotation speeds to around 30,000 rpm, with image quality degrading at speeds higher than this.

Sumo overcomes this limitation with its unique multi-laser optics. Up to three independent lasers are controlled by Fujifilm's patented AOD (Acousto-Optic Deflector) technology to ensure that the laser beams are perfectly aligned. Fujifilm is the first to introduce such technology on an internal drum imagesetter, which results in Sumo's outstanding performance.

In addition, an intelligent database automatically recognizes up to seven different film cassettes when they are loaded into the machine, while a touch-screen control panel makes Sumo simple to operate.

SCALEABLE PRODUCTIVITY

Sumo's multi-laser configuration competes favorably with the best that the competition has to offer, while making no compromise in the reliability and quality you expect from Fujifilm.

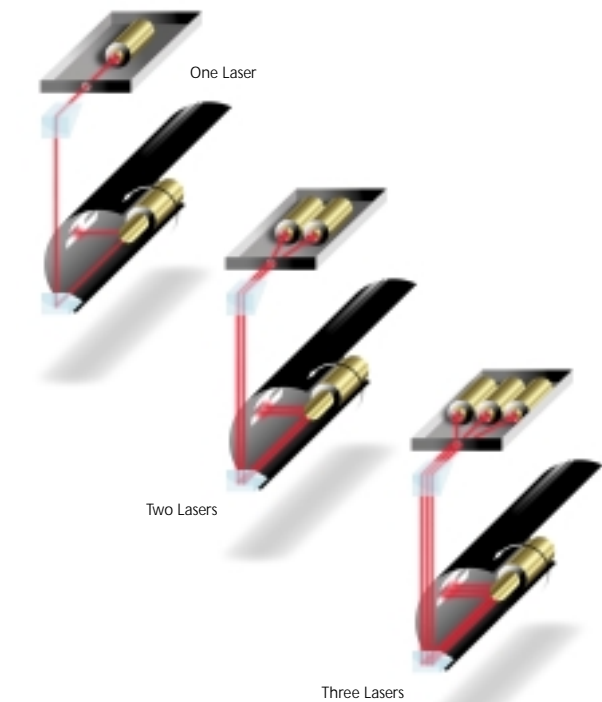

TRUE PLATE READY FILM - THE SUMO WORKFLOW



Sumo is supported by the Fujifilm CelebraNT RIP, Fujifilm HQ-NT RIP and Rampage RIP.

Touch screen, menu select user interface is operator friendly.

Integrated cassette shelf eliminates removal of supply cassettes from Sumo for quick and easy film handling. Plus, an innovative cassette database for media identification—film width, thickness, type and even the amount left in the cassette are indicated. Data for up to 7 cassettes can be entered for quick changes to accommodate different press configurations.

Sumo comes standard with Stoesser or U.S. Bacher Punch. Custom punches available.

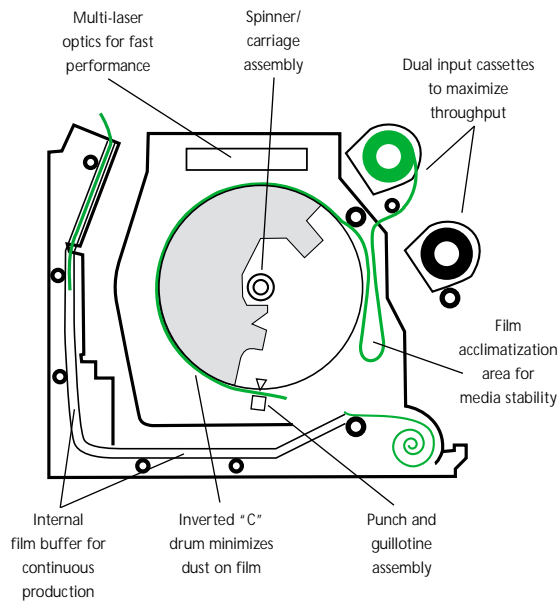

FUJIFILM
GRAPHIC SYSTEMS

1-800-877-0555
www.fujifilm.com

MAKING
Imagesetting
WORK